

Plumon
Centre table,
Assembly instructions

kettal

Plumon

Centre table

Description

3D printing and new technologies offer endless possibilities and open the doors to a vast uncharted territory, on both an industrial and an aesthetic level. These are living products and designs that can change shape throughout the manufacturing process, becoming unique pieces.

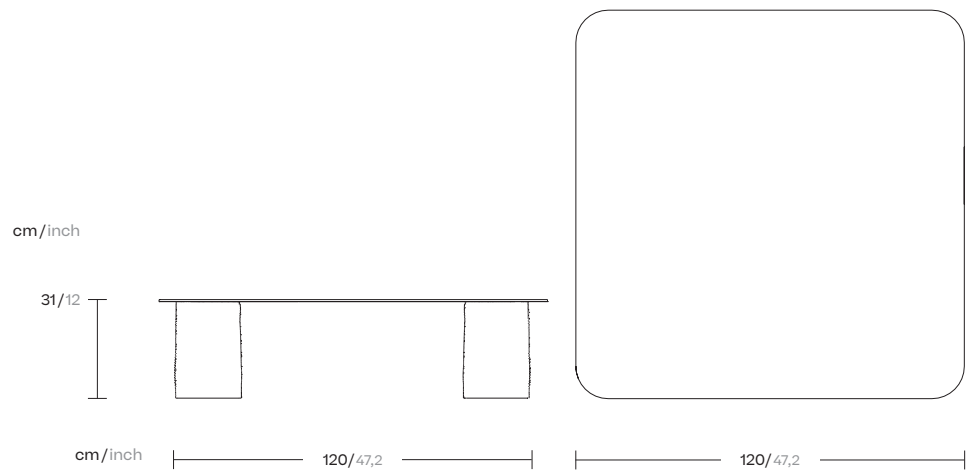

Designer
Patricia Urquiola

Collection
Plumon

Reference
KSA801000

Information

Cleaning Instructions

Glass: Clean with non corrosive, non abrasive cleaners. No scrub pad nor pressure cleaner should be used. Care should be taken not to scratch the powder coated paint on the underside of the glass.

Ceramic:

This symbol on the product or its packaging indicates that it must not be treated as household waste. It should, in fact, be handed in at a recognised collection point for recycling electrical and electronic equipment. For more detailed information about the recycling of this product, please contact your local city office, your household waste disposal service or the shop where you purchased the product.

This product is suitable for indoor and outdoor.

Requirements



2x persons

Plumon

Centre table

- 1 Place the legs vertically on the ground (handle with caution).

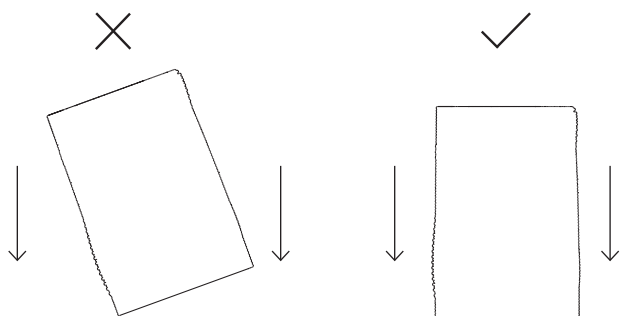

- 2 Position legs at the recommended distance.

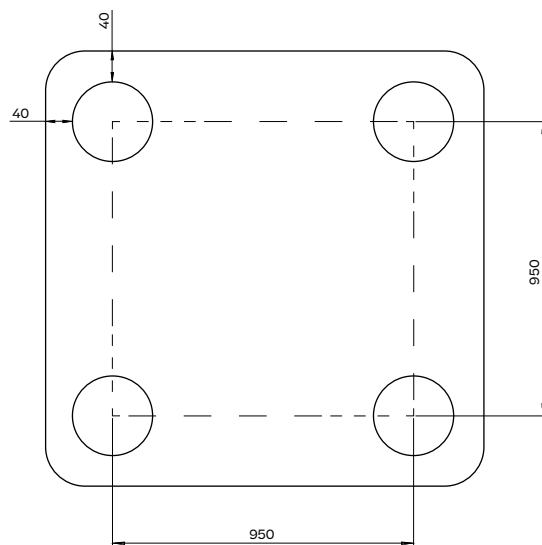

- 3 Place the glass vertically on silicone bumpers

